

# SkillBuild2013

13th-15th November

Young crafts people from around the UK have come together to demonstrate their capabilities at the national final of SkillBuild. This year the event is a part of the Skills Show held at the NEC in Birmingham on 13<sup>th</sup>-15<sup>th</sup> November.

SkillBuild is a highly important national multi-trade competition that takes place annually aiming to promote excellence amongst the UK's young crafts persons. The National Federation of Roofing Contractors Ltd (NFRC) manages the Roof Slating and Tiling, the Roof Sheeting and Cladding and the Reinforced Bituminous Membranes and working in partnership with the Single Ply Roofing Association (SPRA) this year, we also manage the Single Ply competition for SkillBuild.

NFRC and SPRA are fortunate to be able to enjoy the generous support of their Trade Members and the Associate Members who donate materials, resources and prizes for the competition and who are key to the success of the event.

Ray Horwood, NFRC Chief Executive says: ***Moving the competition to the UK Skills Show is a big step forwards. It will allow a greater number of the public to see the excellence that is evident in our young roofers who are a shining light for the future of the industry.***

This year, competitors have taken part in heats up and down the country and have been whittled down by the judges; with the top scorers from each of the heats and disciplines going on to compete in the National Final.

The winners of each competition will receive their prizes at the Gala Presentation Dinner which will be held on the Saturday evening after the competition closes. The winners of the roofing category, if members of NFRC or SPRA will also be invited to The Roofing Awards to be held in London in May 2014 where they will be recognised for their outstanding skills.



THE NATIONAL FEDERATION OF  
ROOFING CONTRACTORS LIMITED

NFRC is the UK's largest roofing trade association; comprised of seven regions, 1000 trade contractors and over 160 Associate Members (manufacturers and service providers) representing over 70% of the roofing industry by value. With a history spanning over 120 years, NFRC has established itself as the voice of the roofing industry, constantly adapting to change and innovation to ensure its members are at the forefront.

For more information go to [www.nfrc.co.uk](http://www.nfrc.co.uk)



## The Worshipful Company of Tylers & Bricklayers

NFRC is proud of its relationship with the City of London livery company which uniquely represents three crafts – roof slating and tiling, wall and floor tiling and bricklaying – which are as important now as they were in 1568 when it received its charter from Queen Elizabeth the First.

Go to [www.tylersandbricklayers.co.uk](http://www.tylersandbricklayers.co.uk)

## SPRA

Single Ply  
Roofing Association

The Single Ply Roofing Association (SPRA) is the trade association representing the UK's single ply roofing industry. Our membership covers the whole supply chain from manufacturers, distributors, specialist contractors and individuals. All our members are independently audited annually against rigorous quality criteria from manufacture to project completion.

For more information go to [www.spra.co.uk](http://www.spra.co.uk)

# ROOF TRAINING

In March 2006 NFRC introduced the Affiliated College Scheme for all colleges involved in training and qualifying apprentice roofers. Originally this was set up as a pilot scheme to support college lecturers with technical information and, where possible, help colleges build greater links with NFRC Associate Members with regards to increasing the amount of materials available for training. Recently in 2013, the affiliated membership was expanded to allow other training providers to join.

As the largest roofing trade association in the UK, NFRC feels a duty to assist these training providers as they endeavour to inspire and train the next generation of roofers, whilst at the same time providing excellent training for existing contractors. NFRC believes that a well-trained and qualified workforce benefits roofing in general, as well as trade member companies, and also clients.

Some of the benefits offered to Affiliate Members include:

- **Free downloads of NFRC technical bulletins and guidance notes**
- **Free attendance at NFRC Health & Safety and Technical Seminars**
- **Free use of the website to advertise courses**
- **Free copies of 'all member circulars' and Update newsletter**
- **Free PDF CITB-CS Roof Training Manuals (sourced through NFRC)**
- **Free access to member sections of the website**
- **Free access to information on recent/future Skills Competitions**



## WHERE YOU CAN TRAIN

There are a number of roofing and construction specialist colleges, training centres and Roof Training Groups (RTG) up and down the country and NFRC, who has strong connections to help our members obtain access to excellent training, is affiliated with a vast number of them and they are as follows:

- **North Highland College**
- **Angus College**
- **Carnegie College**
- **Edinburgh College**
- **Newcastle College**
- **Leeds College of Building**
- **East Midlands Roofing College**
- **Moulton College**
- **Bolton Community College**
- **NCC South**
- **Cornwall College**
- **NCC Midlands**
- **Manchester College**
- **Otley College**
- **South Lanarkshire College**
- **Reid Kerr College**
- **NCC Scotland**
- **North East RTG**
- **Eastern Region RTG**
- **Wales RTG**
- **Scotland RTG**
- **Midlands RTG**
- **South Central RTG**
- **South Coast RTG**
- **Northern Ireland RTG**
- **London & Southern RTG**
- **Yorkshire Independent RTG**
- **North West Independent RTG**
- **South Wales & South West RTG**
- **National Metal Training Group**



For more information head to our website [www.nfrc.co.uk](http://www.nfrc.co.uk).

# ROOF SLATING & TILING

## COMPETITORS

### Scotland

**Competitor: Ian Marshall**  
Employer: Macleod Roofing Ltd  
Tutor: Gary Gordon  
College: Angus College

### South West & South Wales

**Competitor: Connor Martin**  
Employer: Heritage Roofing  
Tutor: Sean Sullivan  
College: St Austell

### North West

**Competitor: Chris Williams**  
Employer: G Timlin Roofing Ltd  
Tutor: Stuart Hill  
College: Bolton College

### Midlands

**Competitor: Calvin Jones**  
Employer: Randell and Janes Roofing Ltd  
Tutor: Ian Scott  
College: NCC Midlands

### Yorkshire & North East

**Competitor: Benjamin Johnson**  
Employer: Roundhay Roofing  
Tutor: Chris Messenger  
College: Leeds College of Building

### London & Southern Counties

**Competitor: Ashley Seamer**  
Employer: Weatherall Roofing Ltd  
Tutor: Alan King  
College: NCC South

### Competitor: Thomas Bates

Employer: Moulton Roofing Ltd  
Tutor: Ian Scott  
College: NCC Midlands

### Northern Ireland

**Competitor: Donal Harkin**  
Employer: D Harkin & Co Roofing Ltd  
Tutor: Gordon Penrose  
College: N. Ireland Roof Training Group

## Marking Scheme

Max. 500  
Marks

Underlay and Support Trays – Tiled Section	30
Underlay and Support Trays – Slated Section	40
Battens and Dry Verge – Tiled Section	50
Battens – Slated Section	60
Tiling – Plain Tiling and PV Modules	100
Slating – Including all pattern Work	170
Marks for overall appearance	20
Health and Safety	30

## GENERAL SPECIFICATIONS

### STRAIGHT AREA

265 x 165 mm Marley Concrete Plain Tiles laid to an ornate design with a minimum 65mm headlap, over 38 x 25mm JB RED Timber Battens, Proctor Roofshield Underlay, Marley support Trays and Dry Verge.

### HIP AREA

John Brash Western Red Cedar Shingles (400mm nominal length) laid to a maximum 125mm gauge, double nailed with two nails per Shingle, over 50 x 25mm JB Red Timber Battens, Proctor Roofshield Underlay and Support Trays. Verge Shingles fixed to specified overhang. Hip cappings fixed to same gauge as the roof and laid with alternate bevells to conceal fixings.

### ABUTMENTS (BOTH SIDES)

Underlay to be turned up at and cut flush with stop board with DPC soakers required to both sides.

## RIG DRAWING

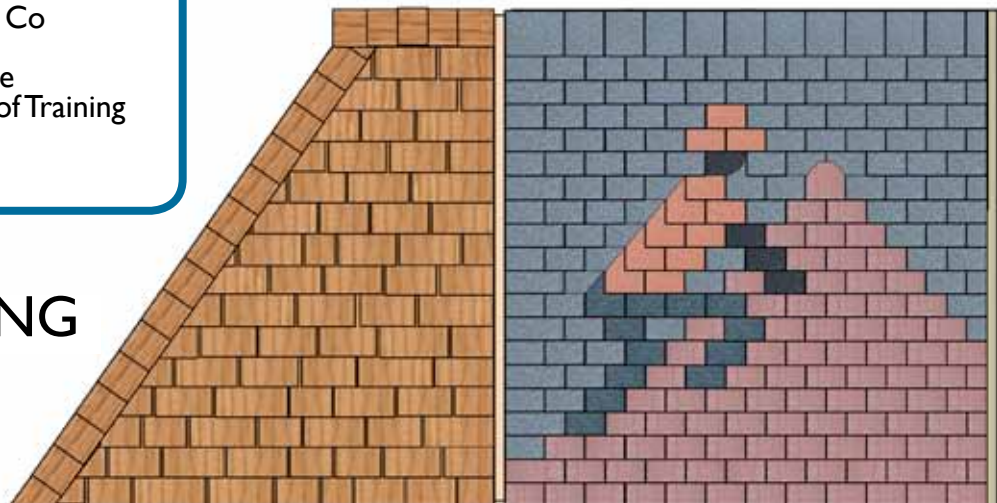

# SINGLE PLY

## COMPETITORS

### Midlands

#### Competitor: Jake Heath

Employer: Advanced Roofing Ltd  
Tutor: Jim Hooker  
College: East Midlands Roofing College

#### Competitor: Paul Hallam

Employer: Advanced Roofing Ltd  
Tutor: Mike Davis  
College: East Midlands Roofing College

### Competitor: Ben Revitt

Employer: Briggs Amasco  
Tutor: Jim Hooker  
College: East Midlands Roofing College

### London & Southern Counties

#### Competitor: Ross Paterson

Employer: DCR Contracts  
Tutor: Chris Bussens  
College: Eastern Region Roof Training Group

## RIG DRAWING

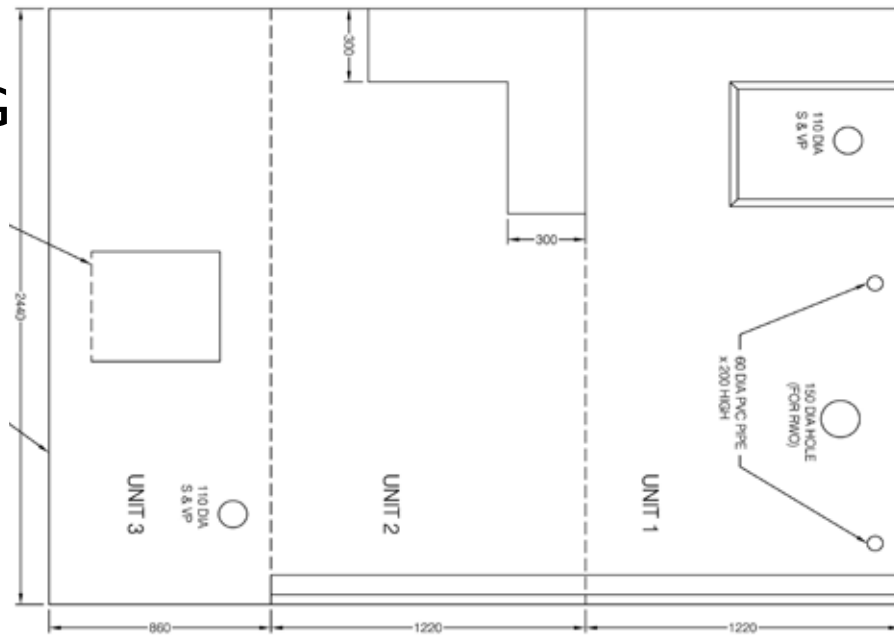

## GENERAL SPECIFICATIONS

Sarnavap 5000/1000 self-adhesive Vapour Control Layer applied to plywood deck. 75mm thick Sarnatherm rigid urethane foil faced insulation board mechanically fastened with SFSintec thermal beak fasteners to the deck or 75mm thick tissue faced Sarnatherm insulation adhered to the VCL with Sarnacol adhesive. Sarnafil membrane to be mechanically fixed using Sarnafast thermal break fasteners or to be adhered to the foil faced insulation with Sarnacol adhesive.

A membrane walk way to be created using Sarnatred. Sarnafil Decorprofile to be welded to the top surface of the roof membrane to create a “standing seam” effect.

All edge details and trims to be finished using incorporating Sarnametal. All installations to be in accordance with the manufacturers specifications.

## Marking Scheme

Max. 100 Marks

Set-up – Materials & Tools	12
Vapour Control Layer	10
Insulation	10
Membrane	20
Welding & Peel Stops	14
Detailing	24
Standing Seams	5
Health and Safety	5

# REINFORCED BITUMINOUS MEMBRANE

## COMPETITORS

### Midlands

**Competitor: Jordan Lane**  
Employer: Lane Roofing Ltd  
Tutor: David Ballantyne  
College: NCC Midlands

### Competitor: Joshua Allen-Sutherland

Employer: Mells Roofing Ltd  
Tutor: David Ballantyne  
College: NCC Midlands

### Scotland

**Competitor: Craig Bonar**  
Employer: Corstorphine Roofing and Building  
Tutor: David Ballantyne  
College: NCC Scotland

### Competitor: Sebastian Rutkowski

Employer: Greenroof UK Ltd  
Tutor: David Ballantyne  
College: NCC Scotland

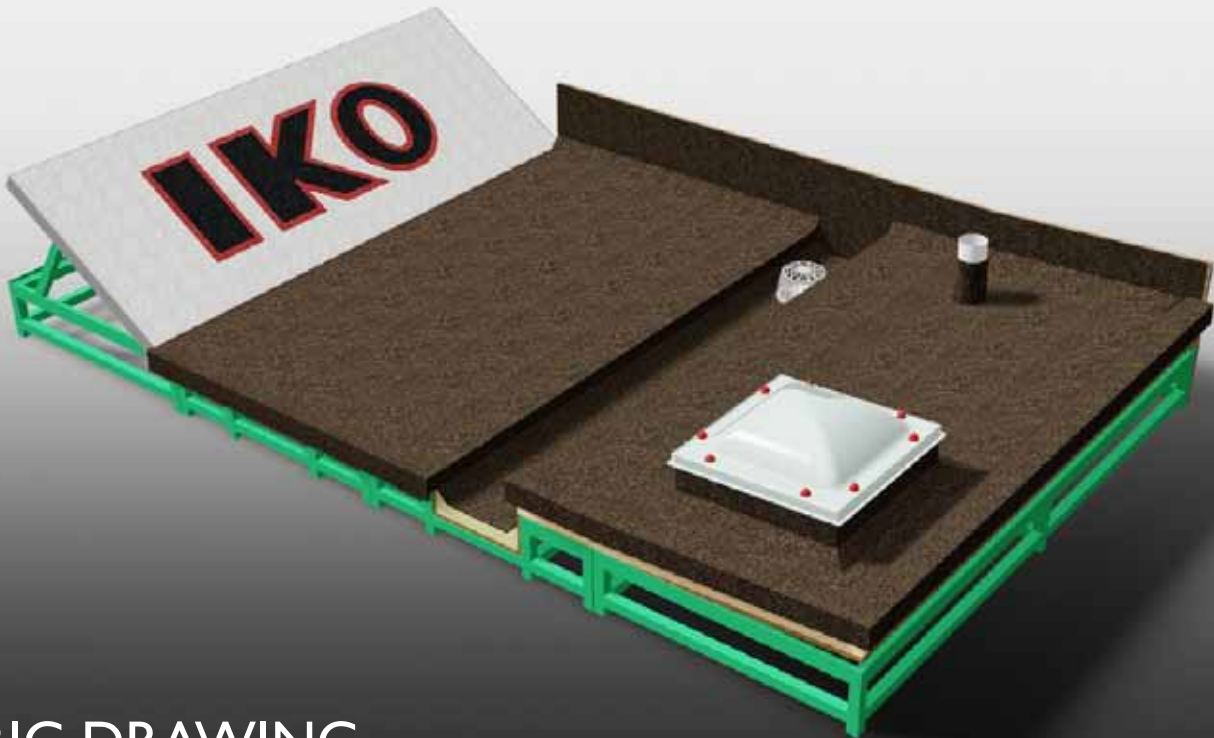

RIG DRAWING

## GENERAL SPECIFICATIONS

The competition rig is split into three main areas, consisting of a warm roof section, a cold roof section, and a pitched section with a decal and logo design.

The warm and cold roof is split by a gutter in the centre. The pitched section overlaps onto the upstand of the cold roof.

This specification includes aspects of cold applied installation utilising self-adhesive membranes, and two part rapid curing bonding adhesives, the capsheets are to be a traditional torch-applied membrane, all supplied by IKO.

Marking Scheme	Max. 500 Marks
Warm Roof	100
Box Gutter	100
Cold Roof	100
Pitched (decal & logo design)	100
Aesthetics	50
Health & Safety	50

# ROOF SHEETING & CLADDING

## COMPETITORS

### South West & South Wales

**Competitor: Adrian Keywood**  
Employer: Associated Roofing & Maintenance  
Tutor: Mike Long  
College: South Wales & South West RTG

**Competitor: Dean Wright**  
Employer: Retain Ltd  
Tutor: Mike Long  
College: South Wales & South West RTG

### Scotland

**Competitor: Craig Owens**  
Employer: Topek Ltd  
Tutor: John Lyndsey  
College: NCC Scotland

**Competitor: Adam Taylor**  
Employer: Roof Linings & Cladding Ltd  
Tutor: John Lyndsey  
College: NCC Scotland

## RIG DRAWING

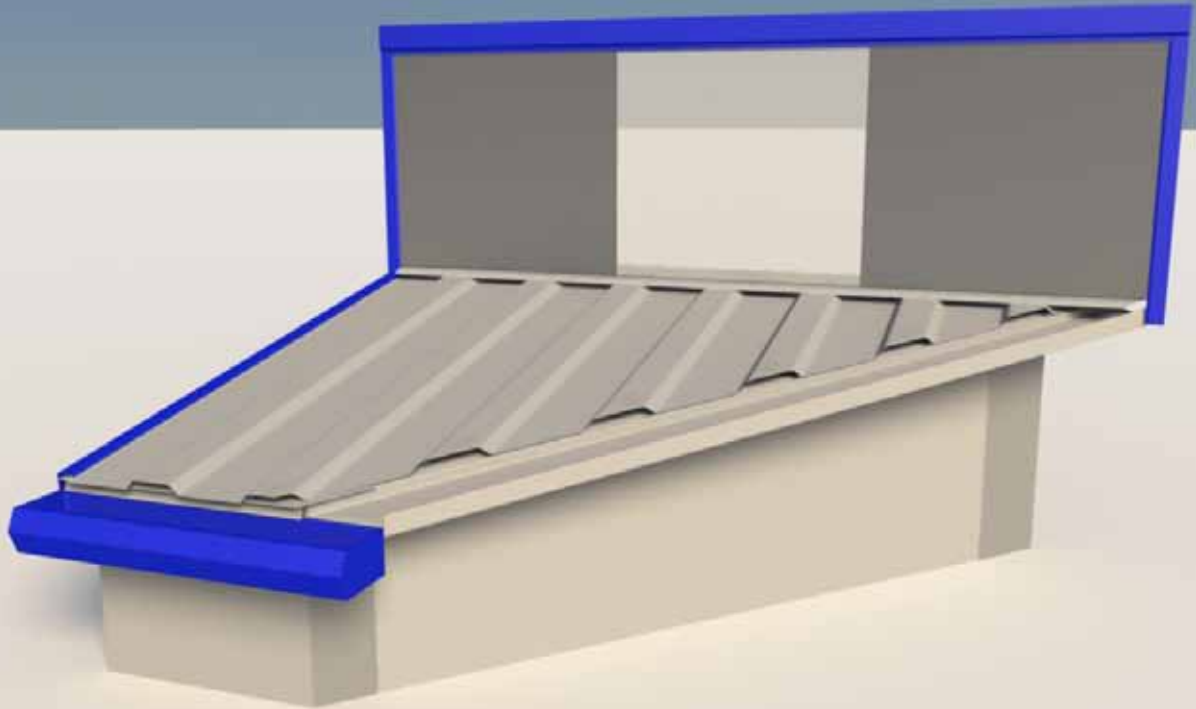

## GENERAL SPECIFICATIONS

### ROOF SECTION

Kingspan KS1000 RW/80 composite panel trapezoidal roof sheets incorporating a KS 1000 polycarbonate rooflight. Details: - verge end, apron abutment, secret gutter, eaves closure and trimline gutter and outlet.

### WALL SECTION

Kingspan KS1000 RW/60 composite panel trapezoidal wall sheets incorporating a KS wall light panel. Details: - parapet capping, corner closure and wall light panel.

### Marking Scheme

Max. 500  
Marks

Preliminaries	30
Roof sheeting	135
Parapet capping	105
Perimeter flashing	150
Overall finish	50
Health & Safety	30

# MAIN SPONSOR SPOTLIGHT

We could not undertake the competition at this high level without continued loyalty, commitment, support and generosity of all our sponsors (see pg 7-8).

## SUPPORTING QUALITY ROOFERS OF THE FUTURE

SkillBuild is a great showcase for young crafts persons to demonstrate their workmanship and technical prowess, culminating in a prestigious final.

Whilst a great competition to support, it does not come without its struggle and complications to organise everything required to make sure it all goes without a hitch from materials, to deliveries, to judging requirements. It's a mammoth task to bring everything together at a number of locations at the right time. However, for a number of years, NFRC has had the help of SIG Roofing and Roofline who support the competition from supplying a range of materials through to managing and performing all of the logistical requirements.

NFRC wanted to find out from SIG why they are committed to supporting this event, so met with Stuart Base, Marketing Manager at SIG. "Quality and excellence is at the very heart of the roofing industry. NFRC and SIG Roofing and Roofline are always keen to recognise people who demonstrate the commitment and passion to a skill that is one of the most important elements of the construction industry," said Stuart.

"Furthermore, to support quality we like to ensure that we provide quality materials including SIGA natural slate for the entrants to work with, knowing that they are using a material that has undergone both strict testing and has the aesthetics that really show off people's work.

"Finally, SIG are experts in sourcing and delivering materials to locations nationwide, using a fleet of over 300 vehicles to ensure that we can deliver to any location no matter the challenge.

"Therefore with our commitment to both quality and the industry along with our skill set it makes perfect sense to fully support the SkillBuild competition."



SIG Roofing & Roofline is the largest specialist distributing merchant of roofing and roofing materials, ranging from pitched, flat, industrial, sustainable, heritage and roofline. They work with specialist and leading manufacturers and also give advice and technical support to their customers.

[www.sigroofing.co.uk](http://www.sigroofing.co.uk)



One difficulty that NFRC faces each competition is being able to move the large built competition rigs around the country and for the past couple of years SIG have been able to come to our assistance by providing vital logistics sponsorship in addition to materials.

# SPONSORS

**A BIG THANKYOU** to the competitors, their employers, mentors, judges, contributors, main sponsor **SIG Roofing and Roofline** (see Page 7) and sponsors shown below:

## KINGSPAN INSULATED PANELS

**Sponsoring: Sheeting and Cladding**

Manufacturer of high quality FIREsafe approved insulated roof, wall and façade systems for the construction industry.



[www.kingspanpanels.com](http://www.kingspanpanels.com)

## THE WORSHIPFUL COMPANY OF TYLERS & BRICKLAYERS

NFRC is proud of its relationship with the City of London livery company which uniquely represents three crafts – roof slating and tiling, wall and floor tiling and bricklaying – which are as important now as they were in 1568 when it received its charter from Queen Elizabeth the First.



[www.tylersandbricklayers.co.uk/](http://www.tylersandbricklayers.co.uk/)

## MARLEY ETERNIT LTD

**Sponsoring: Slating and Tiling**

Manufacturer and supplier of clay and concrete plain and interlocking tiles, double and single lap slates, decorative cladding, profiled sheeting and a range of building boards; in addition to ventilation and dry fix systems, decorative fittings and accessories.



[www.marleyeternit.co.uk](http://www.marleyeternit.co.uk)

## A PROCTOR GROUP LTD

**Sponsoring: Slating and Tiling**

Manufacturer and distributor of Acoustic Insulation, Construction Membranes, Geosynthetic Engineering, Thermal Insulation, Timber Cladding and Vibration Isolation.



[www.proctorgroup.com](http://www.proctorgroup.com)

## JOHN BRASH & CO. LIMITED

**Sponsoring: Slating and Tiling**

Manufacturers of JB-RED® pre-graded roofing battens to BS5534:2003, JB Antislip Plus® Timber Decking and Timber Scaffold Boards. Importers of Western Red Cedar Shingles & Shakes and suppliers of Exterior Timber Cladding, preservative and fire retardant treatments.



[www.johnbrash.co.uk](http://www.johnbrash.co.uk)

## IKO PLC

**Sponsoring: Reinforced Bituminous Membrane**

Manufacturers of flat roofing systems, providing specifiers, designers and building owners with comprehensive technical guidance and support to deliver a truly bespoke and dependable waterproofing solution for every project.



[www.ikogroup.co.uk](http://www.ikogroup.co.uk)

## SIKA SARNAFIL

**Sponsoring: Single Ply**

Sarnafil is the UK's market-leading single ply roofing system for new and refurbishment projects for industrial and commercial buildings of all sizes and functions. The brand has pioneered the use of single ply membranes in the UK since its inception in 1980.



[www.sarnafil.co.uk](http://www.sarnafil.co.uk)

## SIEVERT UK

**Sponsoring: Reinforced Bituminous Membrane**

Manufacture and distribute heating tools for all applications and have quality and safety built in as standard, our range of roofing and heating tools have many innovative features making our range user friendly, reliable and safe to use. Sievert UK are pleased to support SkillBuild and the NFRC.



[www.sievert.se](http://www.sievert.se)