



Elite Roof and Wall Systems

Guaranteed
Roof and Wall
Solutions

Euroclad Group

Euroclad are an international supplier of architectural metal building solutions to the construction industry.

We manufacture an array of building envelope products including roof and wall cladding systems, insulated sandwich panels and architectural flashings and fabrications.



As a unified company with cross industry expertise, our customers can be confident we will deliver building solutions through customer excellence and continually improving performance standards.



We have three main product groups each having their own product offering and place in the market, when combined together form the Euroclad Group, an international supplier of metal building solutions.



Built-up Systems

Euroclad Systems include the range of Elite Roof and Wall built-up systems, featuring an array of architectural profiles.

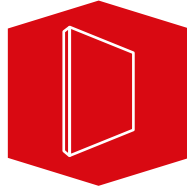

Insulated Panels

Eurobond Panels offers a range of insulated metal sandwich panels systems that can deliver a clean, smooth and aesthetically appealing solution.



Flashings and Fabrications

Euroclad Architectural supply the construction industry with a range of metal flashings, fabrications and rainwater goods.

Celebrating over 40 Years

Today we are a modern business with an established reputation of innovation and quality since our inception in 1981, consistently investing in people and technology to satisfy customer needs.

As part of our commitment to quality, service and the environment, Euroclad operates a Quality Management System approved to BS EN ISO 9001:2015 and an Environmental

Management System approved to BS EN ISO 14001:2015.



Euroclad Elite[®] Roof Systems

Elite Roof Systems are site assembled systems comprising of a liner sheet (or structural deck) separated by a spacer system, with an external profile in steel or aluminium and mineral wool sitting between the sheets to provide thermal and acoustic insulation.



Please scan the QR code or [click here](#) for our Technical Department contact details



The range of systems available provides a variety of aesthetic choice whilst offering a fully integrated and specifiable system.



Used to create roof structures, Elite Systems offer choice, performance and convenience, as well as the peace of mind afforded by an entire system guarantee.



Guaranteed

For up to 30 years with the Elite Plus system guarantee.



Versatile

Can be used for finished pitches as low as 1°, for both curved and tapered applications.



Performance

Provides thermal, airtightness and sound reduction performance.

There is a comprehensive choice of exterior profiles, all of which have inherent benefits. From trapezoidal profiles over structural metal decks to secret fix and standing seam systems incorporating timber decks. The Elite Roof will be an attractive and familiar part of the landscape for many years to come.

Quality controlled manufacturing to BS EN ISO 9001:2015 and comprehensive customer service to complement the choice, performance and convenience of Elite Roof Systems.



Please scan the QR code or [click here](#) for our Technical Department contact details



Elite 1

Elite 1 is recommended for use in designs with a finished roof pitch equal to or greater than 4°.

Barrel vault curved roofs can also be achieved where crown sheet end laps are equal to or greater than 2.5° finished pitch.

The EC 32-167-1000 Roof Profile 1 or EC 32-167-1000 Roof 5F Forward Special external profile is fixed to the Quattro spacer system, which creates the insulation gap between the outer sheet and the EC 19-167-1000 Liner 2 liner.

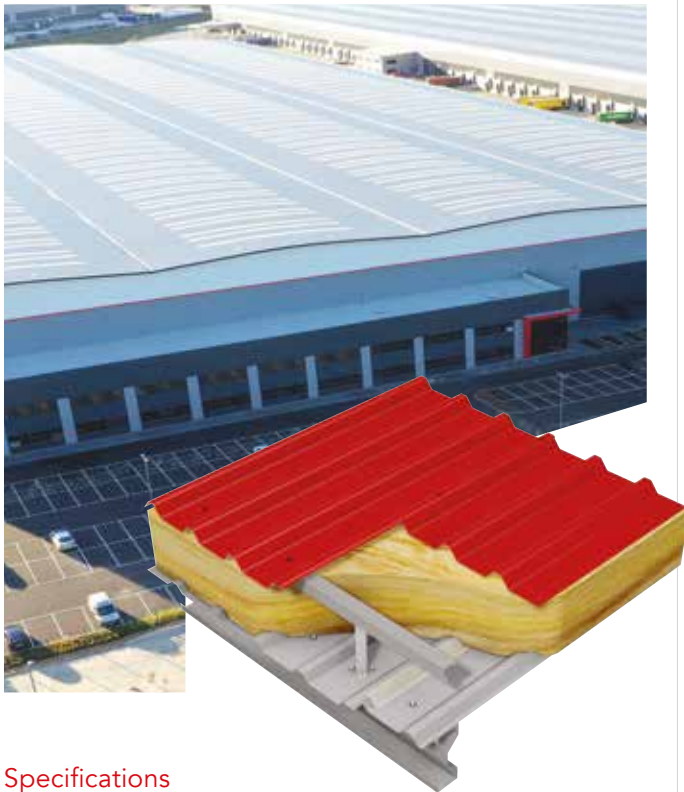

Specifications

External profile	Euroclad EC 32-167-1000 Roof Profile 1 or EC 32-167-1000 Roof 5F Forward Special or 5F 0.7mm steel Colorcoat HPS200 Ultra® / Colorcoat Prisma®
Spacer system	Quattro Bracket and Quattro Bar
Insulation	0.040W/mK Lambda insulation as standard
Internal profile	Euroclad EC 19-167-1000 Liner 2 0.4mm steel
System components	Supplied by Euroclad: Fasteners, standard U-value rooflights, flashings, membranes, tapes, mastic and sealants, fabrications Supplied by others: PV solutions, fall arrest and fall restraint, roof penetrations

Performance

U-value	Quattro bracket	0.040W/mK insulation
0.16W/m ² K AD-L 2021:Volume 2	280mm	280mm
0.17W/m ² K 2013 notional building value compliant	260mm	260mm

Assumptions used in calculation:
Quattro Brackets at 1.167m centres, Quattro Bars at 1.500m centres. 0.040λ (Lambda) 90/90 quilt insulation filling the void between liner sheet and underside of external profile. U-values can be calculated for Elite 1 specifications with alternative Quattro Bracket heights not listed above. Contact the [Technical Team](#) for more information.

Elite 2 Range

Euroclad Elite 2 Range provides a trapezoidal roofing system with a finished roof pitch equal to or greater than 4°. This roofing system includes a Class B non-fragile liner and offers a wide range of U-values.

Barrel vault curved roofs can also be achieved where crown sheet end laps are equal to or greater than 2.5° finished pitch.

The EC 32-167-1000 Roof Profile 1 or EC 32-167-1000 Roof 5F Forward Special external profile is fixed to the Quattro spacer system, which creates the insulation gap between the outer sheet and the EC 32-200-1000 Liner MW5 or EC 32-200-1000 Liner MW5 Swaged. The liner is available with standard or perforated sheets for acoustic purposes.

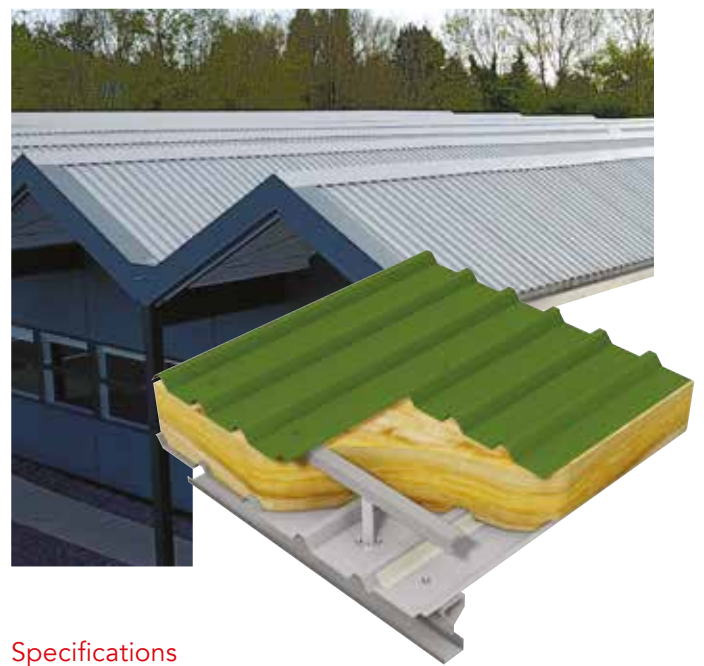

Specifications

External profile	Euroclad EC 32-167-1000 Roof Profile 1 or EC 32-167-1000 Roof 5F Forward Special or 5F 0.7mm steel Colorcoat HPS200 Ultra® / Colorcoat Prisma®
Spacer system	Quattro Bracket and Quattro Bar
Insulation	0.040W/mK Lambda insulation as standard
Internal profile	EC 32-200-1000 Liner MW5 or EC 32-200-1000 Liner MW5 Swaged 0.7mm steel
System components	Supplied by Euroclad: Fasteners, standard U-value rooflights, flashings, membranes, tapes, mastic and sealants, fabrications Supplied by others: PV solutions, fall arrest and fall restraint, roof penetrations

Performance

U-value	Quattro bracket	0.040W/mK insulation
0.16W/m ² K AD-L 2021:Volume 2	280mm	280mm
0.17W/m ² K 2013 notional building value compliant	280mm	280mm

Assumptions used in calculation:
Quattro Brackets at 1.200m centres, Quattro Bars at 1.500m centres. 0.040λ (Lambda) 90/90 insulation quilt filling the void between liner sheet and underside of external profile. U-values can be calculated for Elite 2 and Elite 2 AC2 specifications with alternative Quattro Bracket heights not listed above. Contact the [Technical Team](#) for more information.

Elite 3 Range

Euroclad Elite 3 Range provides a low pitch roofing solution with continuous outer sheets featuring no endlaps and no exposed fixings.

A number of designs can be achieved offering a wide range of U-values.

The SF500 roofing sheet can be used on curved roofs with a minimum radius of 50 meters, which allows ridge heights to be kept to a minimum for a clean low impact roofline.

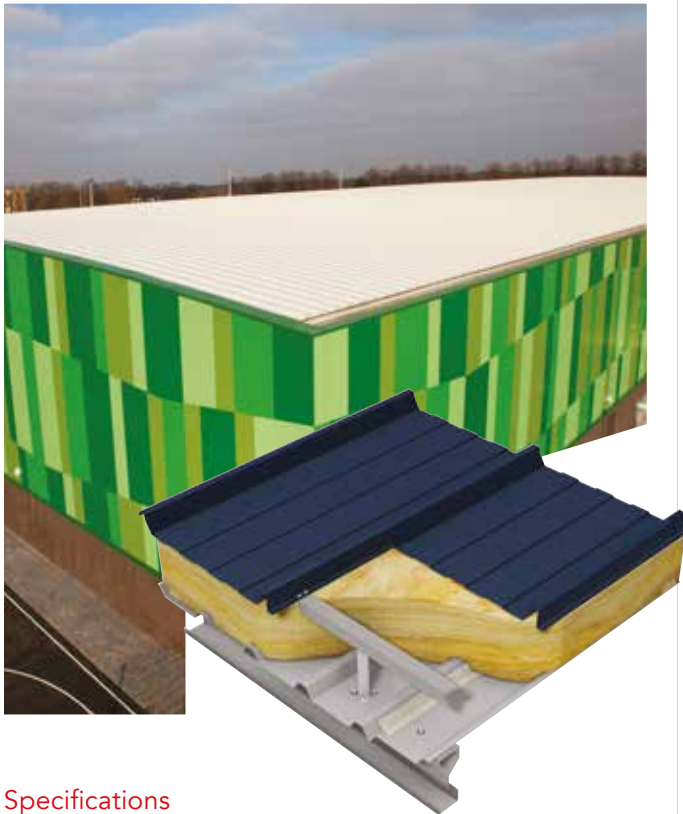

Specifications

External profile	EC 54-500 Secret Fix 0.7mm steel Colorcoat HPS200 Ultra® / Colorcoat Prisma®
Spacer system	Quattro Bracket and Quattro Bar
Insulation	0.040W/mK Lambda insulation as standard –
Internal profile	Euroclad EC 32-200-1000 Liner MW5 or EC 32-200-1000 Liner MW5 Swaged 0.7mm steel
System components	Supplied by Euroclad: Fasteners, standard U-value rooflights, flashings, membranes, non-penetrative clamps for attachment of PV arrays and other roof mounted installations such as walkways, tapes, mastic and sealants, fabrications Supplied by others: PV solutions, fall arrest and fall restraint, roof penetrations

Performance

U-value	Quattro bracket	0.040W/mK insulation
0.16W/m ² K AD-L 2021:Volume 2	300mm	300mm
0.17W/m ² K 2013 notional building value compliant	280mm	280mm

Assumptions used in calculation:
Quattro Brackets at 1.200m centres, Quattro Bars at 1.500m centres.
0.040λ (Lambda) 90/90 insulation quilt filling the void between liner sheet and underside of external profile. U-values can be calculated for Elite 3 and Elite 3 AC2 specifications with alternative Quattro Bracket heights not listed above.
Contact the [Technical Team](#) for more information.

Elite 4 Range

Euroclad Elite 4 Range offers a low pitch standing seam roof option, with no endlaps and no exposed fixings.

Elite 4 Range provides the adaptability needed to achieve aesthetically pleasing yet functional designs for industrial or architectural applications. The Euroseam profile sheet can be used to achieve a whole range of curves from large barrel vaults to multiple curved designs.

The Euroseam® profile can be supplied in natural stucco embossed aluminium, pre-painted PVDF, ARS, Duragloss or Duragloss 5000.



Specifications

External profile	EC 75-400 Euroseam 0.9mm aluminium Plain mill stucco embossed / PVDF / ARS / Duragloss 5000
Spacer system	Quattro Bracket, Quattro Bar and Halters
Insulation	0.040W/mK Lambda insulation as standard
Internal profile	EC 32-200-1000 Liner MW5 or EC 32-200-1000 Liner MW5 Swaged 0.7mm steel
System components	Supplied by Euroclad: Fasteners, standard U-value rooflights, flashings, membranes, non-penetrative clamps for attachment of PV arrays and other roof mounted installations such as walkways Supplied by others: PV solutions, fall arrest and fall restraint, roof penetrations

Performance

U-value	Quattro bracket	0.040W/mK insulation
0.16W/m ² K AD-L 2021:Volume 2	240mm	300mm
0.17W/m ² K 2013 notional building value compliant	240mm	300mm

Assumptions used in calculation:
Quattro Brackets at 1.200m centres, Quattro Bars at 1.500m centres.
0.040λ (Lambda) 90/90 insulation quilt filling the void between liner sheet and underside of external profile. U-values can be calculated for Elite 4 and Elite 4 AC2 specifications with alternative Quattro Bracket heights not listed above.
Contact the [Technical Team](#) for more information.

Elite 5 Range

Euroclad Elite 5 Range provides low pitch roofing solution and can be installed to achieve a wide range of U-values.

The Euroseam® external roof profile is attached to halters which are, in turn, attached to the Quattro spacer system and tophats which together create the insulation gap between the outer sheet and the structural deck.

*Elite 5 AC1 acoustic absorption version is shown.



Specifications

External profile	Euroclad EC 75-400 Euroseam 0.9mm aluminium Plain mill stucco embossed / PVDF / ARS / Duragloss 5000
Spacer system	Quattro Bracket, Quattro Bar and Halters
Insulation	0.040W/mK Lambda insulation as standard
Internal profile	Structural deck
System components	<p>Supplied by Euroclad: Tophats, fasteners, standard U-value rooflights, flashings, membranes, non-penetrative clamps for attachment of PV arrays and other roof mounted installations such as walkways, tapes, mastic and sealants, fabrications</p> <p>Supplied by others: PV solutions, fall arrest and fall restraint, roof penetrations</p>

Performance

U-value	Quattro bracket	0.040W/mK insulation
0.16W/m ² K AD-L 2021:Volume 2	200mm	300mm
0.17W/m ² K 2013 notional building value compliant	180mm	280mm

Assumptions used in calculation:
Quattro Brackets at 1.200m centres, Quattro Bars at 1.500m centres.
0.040λ (Lambda) 90/90 insulation quilt filling the void between deck sheet and underside of external profile. U-values can be calculated for Elite 5, Elite 5 AC1 and Elite 5 AC2 specifications with alternative Quattro Bracket heights not listed above.
Contact the [Technical Team](#) for more information.

Elite 6 Range

Euroclad Elite 6 Range provides low pitch roofing solution and can be installed to achieve a finished pitch down to 1°.

The SF500 external roof profile is fixed to the Quattro spacer system and tophats which creates the insulation gap between the outer sheet and the structural deck.

The SF500 roofing sheet can be used on curved roofs with a minimum radius of 50 meters, which allows ridge heights to be kept to a minimum for a clean low impact roofline.



Specifications

External profile	Euroclad EC 54-500 Secret Fix 0.7mm steel Colorcoat HPS200 Ultra® / Colorcoat Prisma®
Spacer system	Quattro Bracket and Quattro Bar
Insulation	0.040W/mK Lambda insulation as standard
Internal profile	Structural deck
System components	<p>Supplied by Euroclad: Tophats, fasteners, standard U-value rooflights, flashings, membranes, non-penetrative clamps for attachment of PV arrays and other roof mounted installations such as walkways, tapes, mastic and sealants, fabrications</p> <p>Supplied by others: PV solutions, fall arrest and fall restraint, roof penetrations</p>

Performance

U-value	Quattro bracket	0.040W/mK insulation
0.16W/m ² K AD-L 2021:Volume 2	240mm	280mm
0.17W/m ² K 2013 notional building value compliant	220mm	260mm

Assumptions used in calculation:
Quattro Brackets at 1.200m centres, Quattro Bars at 1.500m centres.
0.040λ (Lambda) 90/90 insulation quilt filling the void between deck sheet and underside of external profile. U-values can be calculated for Elite 6, Elite 6 AC1 and Elite 6 AC2 specifications with alternative Quattro Bracket heights not listed above.
Contact the [Technical Team](#) for more information.

Elite 7 Range

Euroclad Elite 7 Range provides a trapezoidal roofing system utilising a Euroclad structural deck fitted directly to the main frame without secondary steelwork.

The EC 32-167-1000 Roof Profile 1 or EC 32-167-1000 Roof 5F Forward Special roof external profile is fixed to the Quattro spacer system and tophats which together create the insulation gap between the outer sheet and the structural deck.

The non-perforated structural decks can also be provided in a perforated option for acoustic purposes.

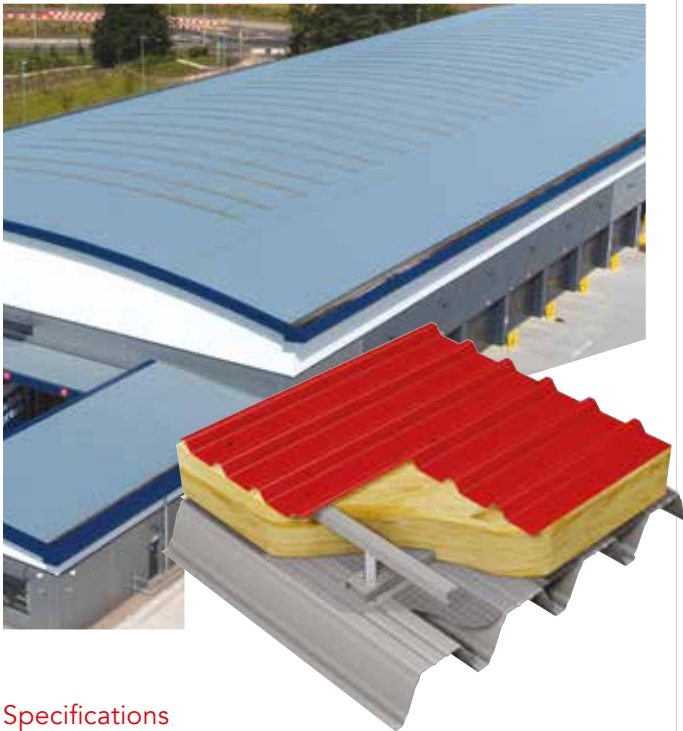

Specifications

External profile	Euroclad EC 32-167-1000 Roof Profile 1 or EC 32-167-1000 Roof 5F Forward Special 0.7mm steel Colorcoat HPS200 Ultra® / Colorcoat Prisma®
Spacer system	Quattro Bracket and Quattro Bar
Insulation	0.040W/mK Lambda insulation as standard
Internal profile	Structural deck
System components	Supplied by Euroclad: Tophats, fasteners, standard U-value rooflights, flashings, membranes, tapes, mastic and sealants, fabrications Supplied by others: PV solutions, fall arrest and fall restraint, roof penetrations

Performance

U-value	Quattro bracket	0.040W/mK insulation
0.16W/m ² K AD-L 2021:Volume 2	240mm	280mm
0.17W/m ² K 2013 notional building value compliant	220mm	260mm

Assumptions used in calculation:
Quattro Brackets at 1.200m centres, Quattro Bars at 1.500m centres.
0.040λ (Lambda) 90/90 insulation quilt filling the void between deck sheet and underside of external profile. U-values can be calculated for Elite 7, Elite 7 AC1 and Elite 7 AC2 specifications with alternative Quattro Bracket heights not listed above.
Contact the [Technical Team](#) for more information.

Elite 8 Range

Euroclad Elite 8 Range offers a streamlined standing seam cold roof solution whilst retaining the attractive aesthetic of a traditional warm roof system.

The system comprises of Euroseam® external roof interlocking profiled sheets and accessories for fixing to timber and OSB decking or structural plywood (18 mm minimum thickness).

The system is applicable to new and existing roof spaces to offer a modernised finish without the need to achieve specific thermal and acoustic performance values.

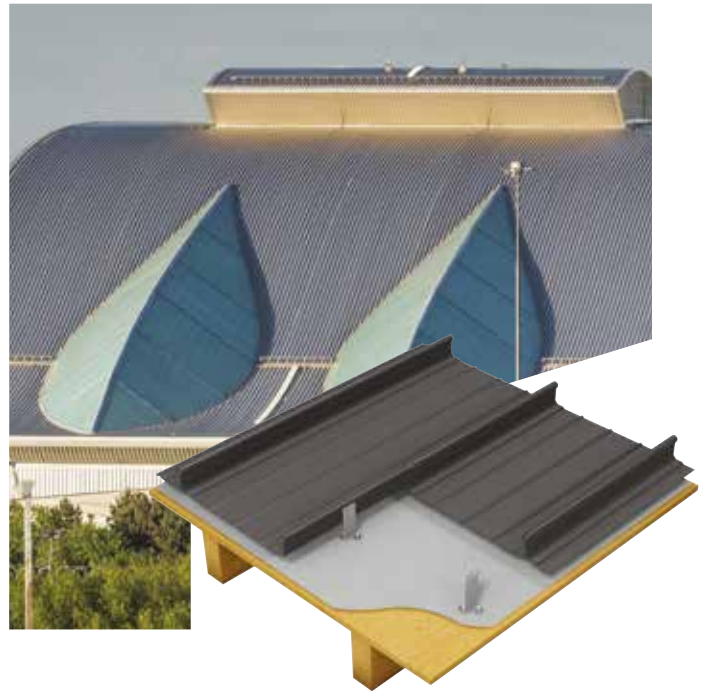

Specifications

External profile	Euroclad EC 75-400 Euroseam 0.9mm aluminium Plain mill stucco embossed / PVDF / ARS / Duragloss 5000
Spacer system	Halters
Insulation	0.040W/mK Lambda insulation as standard
Internal profile	Structural timber deck (by others)
System components	Supplied by Euroclad: Fasteners, standard U-value rooflights, flashings, membranes, non-penetrative clamps for attachment of PV arrays and other roof mounted installations such as walkways, tapes, mastic and sealants, fabrications Supplied by others: PV solutions, fall arrest and fall restraint, roof penetrations



Elite 9 Range

Euroclad Elite 9 Range provides a standing seam warm roof solution. The system comprises of Euroseam® external roof interlocking profiled sheets, compressed quilt insulation and accessories for fixing to timber and OSB decking or structural plywood (18mm minimum thickness).

The system provides a guaranteed solution for new and existing roof spaces to offer a modernised finish whilst meeting project specific thermal and acoustic performance requirements and allowing more freedom of design.



Specifications

External profile	Euroclad EC 75-400 Euroseam 0.9mm aluminium Plain mill stucco embossed / PVDF / ARS / Duragloss 5000
Spacer system	Quattro Bracket, Quattro Bar and Halters
Insulation	0.040W/mK Lambda insulation as standard
Internal profile	Structural timber deck (by others)
System components	<p>Supplied by Euroclad: Tophats, fasteners, standard U-value rooflights, flashings, membranes, non-penetrative clamps for attachment of PV arrays and other roof mounted installations such as walkways, tapes, mastic and sealants, fabrications</p> <p>Supplied by others: PV solutions, fall arrest and fall restraint, roof penetrations</p>

Performance

U-value	Quattro bracket	0.040W/mK insulation
0.16W/m ² K AD-L 2021:Volume 2	200mm	300mm
0.17W/m ² K 2013 notional building value compliant	180mm	280mm

Assumptions used in calculation:
 Quattro Brackets at 1.200m centres, Quattro Bars at 1.500m centres.
 0.040λ (Lambda) 90/90 insulation quilt filling the void between plywood deck and underside of external profile. U-values can be calculated for Elite 9 specifications with alternative Quattro Bracket heights not listed above.
 Contact the [Technical Team](#) for more information.

Elite 10 Range

Euroclad Elite 10 Range offers a secret fixed cold roof solution whilst retaining the attractive aesthetic of a traditional warm roof system.

The SF500 snap fix overlap profile enables a quick and simple installation. The system comprises of interlocking profiled sheets and accessories for fixing to timber and OSB decking or structural plywood (18mm minimum thickness).

The system allows for finished pitches as low as 1° and can also self-curve to a 50 metre radius (convex).



Specifications

External profile	Euroclad EC 54-500 Secret Fix 0.7mm steel Colorcoat HPS200 Ultra® / Colorcoat Prisma®
Insulation	0.040W/mK Lambda insulation as standard
Internal profile	Structural timber deck (by others)
System components	<p>Supplied by Euroclad: Fasteners, standard U-value rooflights, flashings, membranes, non-penetrative clamps for attachment of PV arrays and other roof mounted installations such as walkways, tapes, mastic and sealants, fabrications</p> <p>Supplied by others: PV solutions, fall arrest and fall restraint, roof penetrations</p>

Elite 11 Range

Euroclad Elite 11 Range provides a secret fixed warm roof solution.

The SF500 snap fix overlap profile enables a quick and simple installation and comprises of the interlocking profiled sheets, compressed quilt insulation and accessories for fixing to timber and OSB decking or structural plywood (18mm minimum thickness).

The system provides a guaranteed, sustainable solution allowing for finished pitches as low as 1° and can also self-curve to a 50 metre radius (convex). The system offers thermal and acoustic performance values and freedom of design.



Specifications

External profile	Euroclad EC 54-500 Secret Fix 0.7mm steel Colorcoat HPS200 Ultra® / Colorcoat Prisma®
Spacer system	Quattro Bracket and Quattro Bar
Insulation	0.040W/mK Lambda insulation as standard
Internal profile	Structural timber deck (by others)
System components	<p>Supplied by Euroclad: Tophats, fasteners, standard U-value rooflights, flashings, membranes, non-penetrative clamps for attachment of PV arrays and other roof mounted installations such as walkways, tapes, mastic and sealants, fabrications</p> <p>Supplied by others: PV solutions, fall arrest and fall restraint, roof penetrations</p>

Performance

U-value	Quattro bracket	0.040W/mK insulation
0.16W/m ² K AD-L 2021:Volume 2	240mm	280mm
0.17W/m ² K 2013 notional building value compliant	220mm	260mm

Assumptions used in calculation:
Quattro Brackets at 1.200m centres, Quattro Bars at 1.500m centres.
0.040λ (Lambda) 90/90 insulation quilt filling the void between deck sheet and plywood deck. U Values can be calculated for Elite 11 specifications with alternative Quattro Bracket heights not listed above.
Contact the [Technical Team](#) for more information.

Case Study

Project

Midlands Logistic Park

Products

Euroclad Elite Systems

Walls: Elite 51 and Elite 55

Roof: Elite 1 and Elite 2

Location

Corby



The Project

Midlands Logistics Park is one of the largest logistics developments in the UK. Strategically located on the vital A14 route south west of Corby, that forms part of the Trans European Network (TENTEC), the site consists of four state-of-the-art units, providing a staggering 2.5 million sq ft of storage and distribution space. The park delivers an integral service to businesses wishing to transport goods across the country and provides some 2,200 jobs to the local area.

Started in 2018, the project aimed to deliver high specification warehouses that sit comfortably within the surrounding landscape. Main contractors, Volker Fitzpatrick Limited, specified Euroclad Group's Elite Wall and Roof Systems for each of the four units. Continuing a long track record of delivering mega projects, Euroclad worked closely with the supply chain, providing support from planning right through to delivery and installation, helping to facilitate construction of this ambitious project on time and to an exceptional standard.

The Challenge

Built on the site of a former British Steel quarry, Midlands Logistics Park spans 150 acres. The project's key challenge was to deliver high performance warehouse units which respond to adjoining land uses and minimise impact on the surrounding environment. Sustainability was at the heart of the development from the outset, prioritising the creation of resource-efficient, low-carbon and BREEAM certified buildings. In addition, the vast scale of the project required seamless product manufacture and order management to ensure timely processing and delivery, keeping the build on track.

Euroclad's Elite Wall and Roof Systems were specified to provide an integrated building solution that met the exacting standards of the units' occupiers. The Elite Systems' excellent technical services and dedicated account management ensured that the demands of this large-scale development were fully met.

Action

Euroclad's Elite Systems 51 vertical wall cladding was used in conjunction with Elite Systems 55 horizontal wall cladding to differentiate between different areas of the external elevations and create visual interest. The cladding solutions were specified with a simple, muted colour palette in Anthracite, Pure Grey and Hamlet Colorcoat HPS200 Ultra® by Tata Steel. The wall cladding systems comprise 32/1000 reverse profile steel sheeting fixed to the Quattro spacer system. The mineral wool insulation of the Elite 51 and 55 systems are housed between the outer sheet and the 19/1000 white enamelled liner of the respective systems, support the units' excellent thermal performance.

Complimenting the profiled wall cladding, Euroclad Elite Roof Systems 1 and 2 were installed to create the undulating barrel roofs, establishing a gentle eaves line that helps to minimise the visual impact of the large units. Comprising of pre-finished steel with a profiled liner sheet and 0.040W/mK Lambda insulation, fixed to a Quattro spacer system. The Elite roofing solutions further support the efficiency of the warehousing facilities. Specified with Goosewing Grey Colorcoat HPS200 Ultra® by Tata Steel, the profile curved roofing sheets lighten the upper mass of the warehouses. Offering advanced protection from corrosion and weathering, the Colorcoat HPS200 Ultra® finish to both the roof and walls will ensure the units continue to look their best for decades to come.

Results

Midlands Logistics Park was designed with sustainability in mind. The cladding and insulation within the Elite Systems contributed credits towards BREEAM certification. Units 1 and 2 within the park have both achieved BREEAM 'Very Good' with Unit 4, which was completed in April 2021, achieving BREEAM 'Excellent'. All builds have achieved an Energy Performance Certificate (EPC) rating of A.

Unit 1, secured by flagship logistics company Eddie Stobart on a 20 year lease, recently won "Deal of the year in the over 250,000 sq ft unit" at the Industrial Agents Society (IAS) Awards.

Euroclad Elite® Wall Systems

Elite Wall Systems provide a range of cladding components that combine to form a guaranteed insulated wall system with defined tested and accredited performance. Contact the Technical Department for more information.



Please scan the QR code or [click here](#) for our Technical Department contact details



An Elite System is a built-up metal wall solution which offers choice, performance and an entire system guarantee.



Available in a range of wall cladding profiles which can be installed vertically or horizontally, offering a variety of designs and performance to suit a range of building facades.



Guaranteed

For up to 30 years with the Elite Plus system guarantee.



Versatile

Can be used for a multitude of wall applications, all with inherent design flexibility.



Performance

Provides thermal, airtightness, fire resistance, reaction to fire and sound reduction performance.

Elite Systems are a range of integrated constructions which are guaranteed, specifiable metal cladding systems. The systems feature tested and accredited performance, benefiting contractors with quick and easy installation and offering designers flexibility and peace of mind. Contact the Technical Department for more information.

A viable solution for your vertical or horizontal cladding needs.



Please scan the QR code or [click here](#) for our Technical Department contact details



Elite 50 Range

Our Euroclad Elite 50 Range is a cladding system with an aesthetically pleasing vertical half-round steel profile (EC 50-200-1000 Wall) fixed to the Quattro spacer system with compressed quilt insulation restrained between the outer sheet and the EC 19-167-1000 Liner 2 bright white liner. At the time of issue, Euroclad Group are the sole supplier of the unique half-round profile in the UK.

The system provides a guaranteed solution to overcome project specific thermal and acoustic requirements whilst offering a desirable and modernised finish.



Specifications

External profile	EC 50-200-1000 Wall Half Round Profile 0.7mm steel Colorcoat Prisma®
Spacer system	Quattro Bracket and Quattro Bar
Insulation	0.040W/mK Lambda insulation as standard
Internal profile	Euroclad EC 19-167-1000 Liner 2 0.4mm steel
System components	Fasteners, flashings, membranes, tapes, mastic and sealants, fabrications

Performance

U-value	Quattro bracket	0.040W/mK insulation
0.26W/m²K		
Limiting U-Value for new or replacement walls ADL 2021:Volume 2 incorporating 2023 amendments	180mm	180mm
0.20W/m²K	220mm	220mm

Other U-values are available. Please refer to our Technical Data Sheets.

Fire resistance of both FR15 and FR30 available. Please contact our [Technical Department](#) for further information.

Elite 51 Range

Euroclad Elite 51 Range is a modular and guaranteed solution for vertical cladding.

The system comprises of a trapezoidal (EC 32-167-1000 Wall Reverse Profile) profile sheet fixed to our Quattro spacer system with compressed quilt insulation retained between the outer sheet and the EC 19-167-1000 Liner 2 liner.

The system can be adapted to meet project specific thermal and acoustic requirements whilst offering a modernised external finish to suit local surroundings.



Specifications

External profile	EC 32-167-1000 Wall Reverse Profile 0.7mm steel Colorcoat Prisma® / Colorcoat HPS200 Ultra®
Spacer system	Quattro Bracket and Quattro Bar
Insulation	0.040W/mK Lambda insulation as standard
Internal profile	Euroclad EC 19-167-1000 Liner 2 0.4mm steel
System components	Fasteners, flashings, membranes, tapes, mastic and sealants, fabrications

Performance

U-value	Quattro bracket	0.040W/mK insulation
0.26W/m²K		
Limiting U-Value for new or replacement walls ADL 2021:Volume 2 incorporating 2023 amendments	180mm	180mm
0.20W/m²K	220mm	220mm

Other U-values are available. Please refer to our Technical Data Sheets.

Fire resistance of both FR15 and FR30 available. Please contact our [Technical Department](#) for further information.

Elite 52 Range

Euroclad Elite 52 Range offers the same performance characteristics and build-up of the Elite 51 Range substituting the 32-167-1000 reverse profile with the EC 32-200-1000 Wall MW5 Reverse profile, with its broader crowns and optional swages.

The external sheeting is fixed to the Quattro spacer system, creating the insulation cavity between the outer sheet and the EC 19-167-1000 Liner 2 liner.

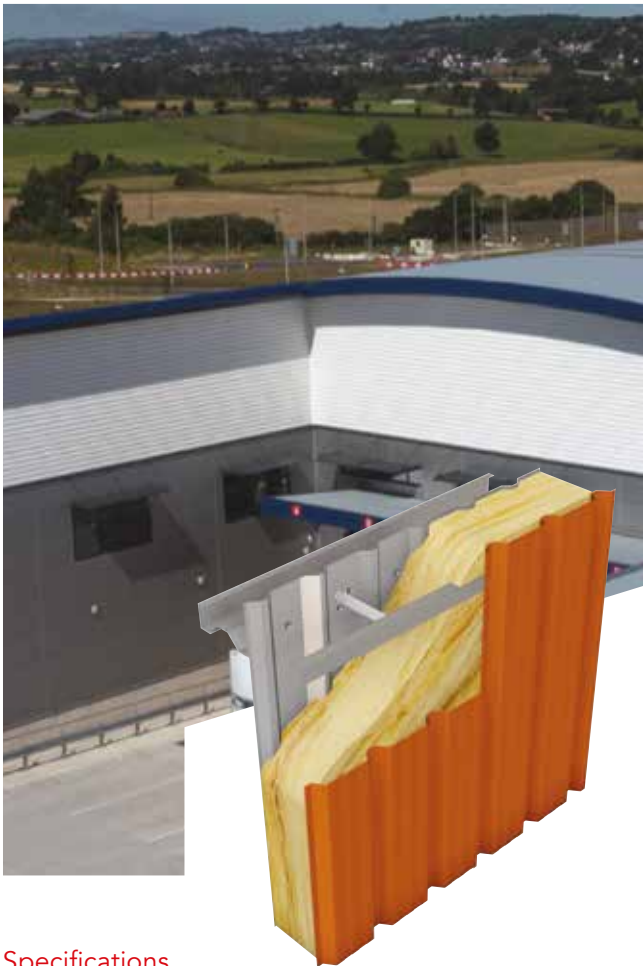

Specifications

External profile	EC 32-200-1000 Wall MW5 Reverse profile 0.7mm steel Colorcoat Prisma® / Colorcoat HPS200 Ultra®
Spacer system	Quattro Bracket and Quattro Bar
Insulation	0.040W/mK Lambda insulation as standard
Internal profile	Euroclad EC 19-167-1000 Liner 2 0.4mm steel
System components	Fasteners, flashings, membranes, tapes, mastic and sealants, fabrications

Performance

U-value	Quattro bracket	0.040W/mK insulation
0.26W/m ² K		
Limiting U-Value for new or replacement walls ADL 2021:Volume 2 incorporating 2023 amendments	180mm	180mm
0.20W/m ² K	220mm	220mm

Other U-values are available. Please refer to our Technical Data Sheets.

Fire resistance of both FR15 and FR30 available. Please contact our [Technical Department](#) for further information.

Elite 53 Range

Euroclad Elite 53 Range is a cladding solution which comprises of a sinusoidal steel sheet (EC 19-76-990 13.5_3 Sinusoidal) fixed to the Quattro spacer system with compressed quilt insulation housed between the outer sheet and the EC 19-167-1000 Liner 2 bright white liner profile.

The eye-catching sinusoidal (also referred to as corrugated) profile is increasingly popular for alluring modern metal constructions.

This is a guaranteed system which also meets project specific thermal and acoustic performance requirements.

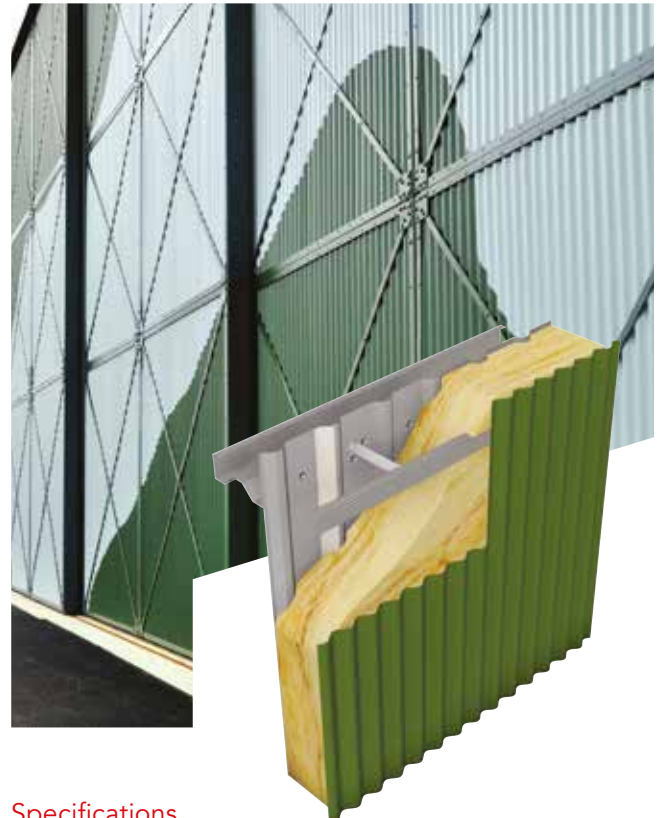

Specifications

External profile	EC 19-76-990 13.5_3 Sinusoidal profile 0.5mm steel Colorcoat HPS200 Ultra®
Spacer system	Quattro Bracket and Quattro Bar
Insulation	0.040W/mK Lambda insulation as standard
Internal profile	Euroclad EC 19-167-1000 Liner 2 0.4mm steel
System components	Fasteners, flashings, membranes, tapes, mastic and sealants, fabrications

Performance

U-value	Quattro bracket	0.040W/mK insulation
0.26W/m ² K		
Limiting U-Value for new or replacement walls ADL 2021:Volume 2 incorporating 2023 amendments	180mm	180mm
0.20W/m ² K	220mm	220mm

Other U-values are available. Please refer to our Technical Data Sheets.

Fire resistance of both FR15 and FR30 available. Please contact our [Technical Department](#) for further information.

Elite 54 Range

Euroclad Elite 54 Range offers a modular, guaranteed and attractive vertical cladding solution offering a contemporary finish.

The system meets project specific thermal and acoustic performance requirements and comprises of the Opus interlocking secret fix plank profile which offers a distinct look for facades and soffits within industrial, commercial and domestic settings.

The Opus planks are fixed directly to Quattro support bars with compressed quilt insulation to meet project specific acoustic and thermal requirements.



Specifications

External profile	Euroclad EC Opus 25-150 Wall (3mm Gaps), EC Opus 25-200 Wall (3mm Gaps), EC Opus 25-200 Wall (10mm Gaps) or EC Opus 25-200 Wall (20mm Gaps) 0.7mm steel Colorcoat HPS200 Ultra® / Colorcoat Prisma®
Spacer system	Quattro Bracket and Quattro Bar
Insulation	0.040W/mK Lambda insulation as standard
Internal profile	Euroclad EC 19-167-1000 Liner 2 0.4mm steel
System components	Fasteners, flashings, membranes, tapes, mastic and sealants, fabrications

Performance

U-value	Quattro bracket	0.040W/mK insulation
0.26W/m ² K		
Limiting U-Value for new or replacement walls ADL 2021:Volume 2 incorporating 2023 amendments	180mm	180mm
0.20W/m ² K	220mm	220mm

Other U-values are available. Please refer to our Technical Data Sheets.

Fire resistance of both FR15 and FR30 available. Please contact our [Technical Department](#) for further information.

Elite 55 Range

Euroclad Elite 55 Range is a guaranteed solution for horizontal cladding.

The system comprises of EC 32-167-1000 Wall Reverse Profile sheeting fixed to the Quattro spacer system with compressed quilt insulation sitting between the outer sheet and the EC 19-167-1000 Liner 2 liner sheet.

The system meets project specific thermal and acoustic performance requirements whilst offering a modernised building envelope.

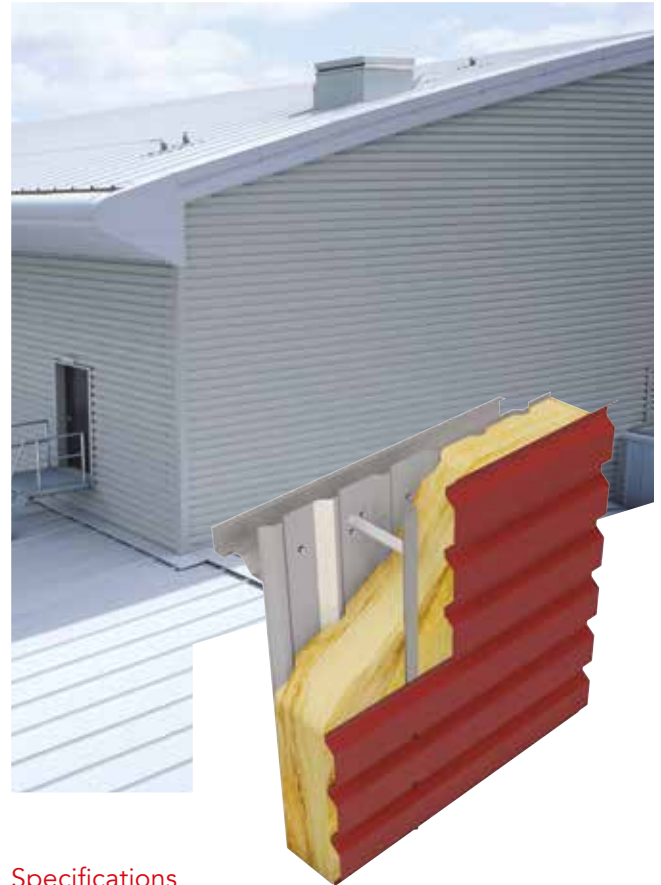

Specifications

External profile	EC 32-167-1000 Wall Reverse Profile 0.7mm steel Colorcoat HPS200 Ultra® / Colorcoat Prisma®
Spacer system	Quattro Bracket and Quattro Bar
Insulation	0.040W/mK Lambda insulation as standard
Internal profile	Euroclad EC 19-167-1000 Liner 2 0.4mm steel
System components	Fasteners, flashings, membranes, tapes, mastic and sealants, fabrications

Performance

U-value	Quattro bracket	0.040W/mK insulation
0.26W/m ² K		
Limiting U-Value for new or replacement walls ADL 2021:Volume 2 incorporating 2023 amendments	180mm	180mm
0.20W/m ² K	220mm	220mm

Other U-values are available. Please refer to our Technical Data Sheets.

Fire resistance of both FR15 and FR30 available. Please contact our [Technical Department](#) for further information.

Elite 56 Range

Euroclad Elite 56 Range offers the same performance characteristics and build-up of Elite 55 substituting the EC 32-167-1000 Wall Reverse Profile with the EC 32-200-1000 Wall MW5 Reverse profile, with its broader, plank-like profile and optional swages.

The external sheeting is fixed to the Quattro spacer system, creating the insulation cavity between the outer sheet and the EC 19-167-1000 Liner 2 liner which is repleted with compressed quilt insulation.

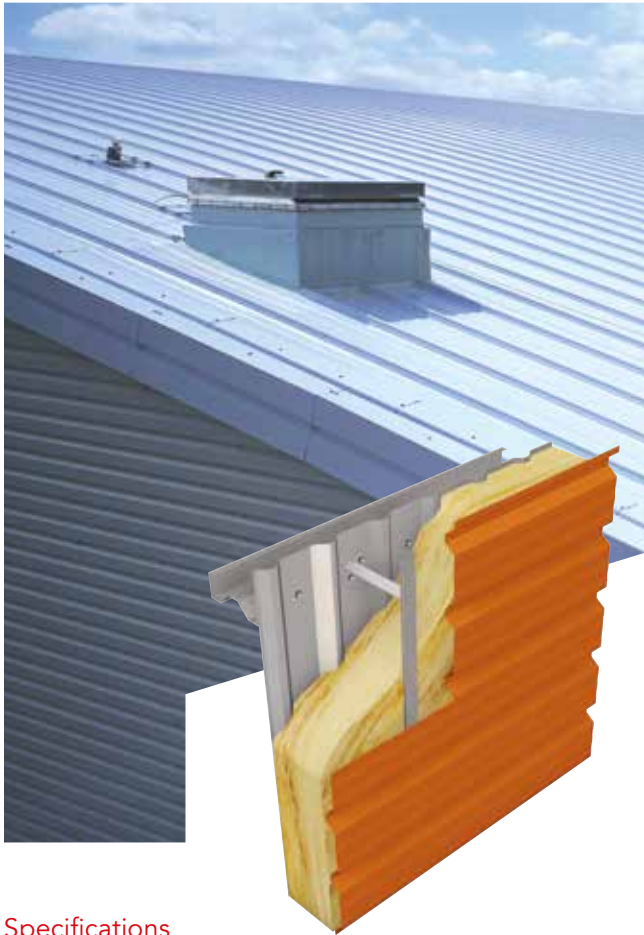

Specifications

External profile	EC 32-200-1000 Wall MW5 Reverse profile 0.7mm steel Colorcoat HPS200 Ultra® / Colorcoat Prisma®
Spacer system	Quattro Bracket and Quattro Bar
Insulation	0.040W/mK Lambda insulation as standard
Internal profile	Euroclad EC 19-167-1000 Liner 2 0.4mm steel
System components	Fasteners, flashings, membranes, tapes, mastic and sealants, fabrications

Performance

U-value	Quattro bracket	0.040W/mK insulation
0.26W/m ² K		
Limiting U-Value for new or replacement walls ADL 2021:Volume 2 incorporating 2023 amendments	180mm	180mm
0.20W/m ² K	240mm	240mm

Other U-values are available. Please refer to our Technical Data Sheets.

Fire resistance of both FR15 and FR30 available. Please contact our [Technical Department](#) for further information.

Elite 57 Range

Euroclad Elite 57 Range is an aesthetically pleasing horizontal cladding solution which comprises of a sinusoidal extended steel sheet (EC 19-76-990 13.5_3 Sinusoidal) fixed to the Quattro spacer system with compressed quilt insulation housed between the outer sheet and the EC 19-167-1000 Liner 2 bright white liner profile.

The eye-catching sinusoidal (also referred to as corrugated) profile is increasingly popular for alluring modern metal constructions.

This is a guaranteed system which also meets project specific thermal and acoustic performance requirements.

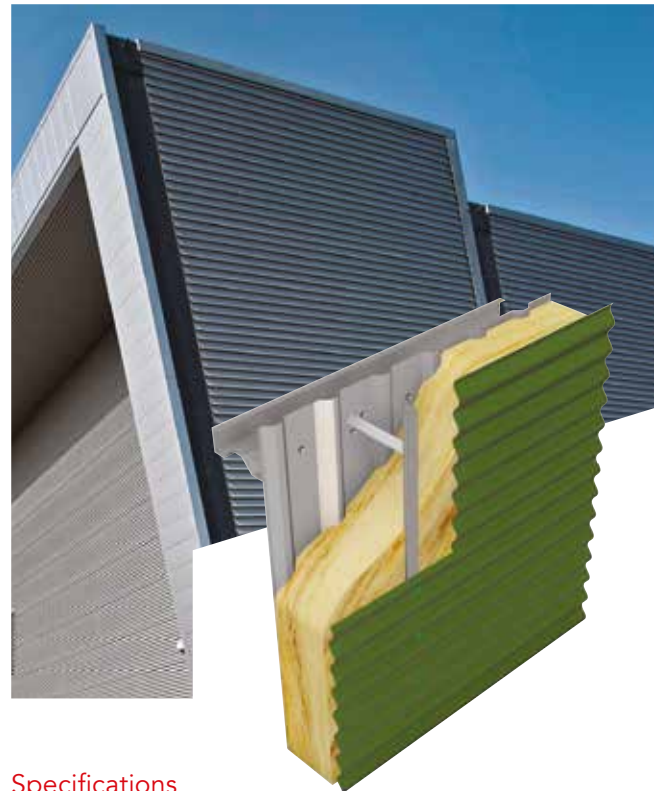

Specifications

External profile	EC 19-76-990 13.5_3 Sinusoidal profile 0.7mm steel Colorcoat HPS200 Ultra® / Colorcoat Prisma®
Spacer system	Quattro Bracket and Quattro Bar
Insulation	0.040W/mK Lambda insulation as standard
Internal profile	Euroclad EC 19-167-1000 Liner 2 0.4mm steel
System components	Fasteners, flashings, membranes, tapes, mastic and sealants, fabrications

Performance

U-value	Quattro bracket	0.040W/mK insulation
0.26W/m ² K		
Limiting U-Value for new or replacement walls ADL 2021:Volume 2 incorporating 2023 amendments	180mm	180mm
0.20W/m ² K	240mm	240mm

Other U-values are available. Please refer to our Technical Data Sheets.

Fire resistance of both FR15 and FR30 available. Please contact our [Technical Department](#) for further information.

Elite 58 Range

Euroclad Elite 58 Range offers a guaranteed and attractive horizontal cladding solution with a contemporary finish.

The system meets project specific thermal and acoustic performance requirements and comprises of the concealed fix Opus interlocking secret fix plank profile which offers a distinct look for facades and soffits. The Opus planks are fixed directly to Quattro support bars and compressed quilt insulation sits between the outer sheet and the EC 19-167-1000 Liner 2 liner sheet.



Specifications

External profile	EC Opus 25-150 Wall (3mm Gaps), EC Opus 25-200 Wall (3mm Gaps), EC Opus 25-200 Wall (10mm Gaps) or EC Opus 25-200 Wall (20mm Gaps) 0.7mm steel Colorcoat HPS200 Ultra® / Colorcoat Prisma®
Spacer system	Quattro Bracket and Quattro Bar
Insulation	0.040W/mK Lambda insulation as standard
Internal profile	Euroclad EC 19-167-1000 Liner 2 0.4mm steel
System components	Fasteners, flashings, membranes, tapes, mastic and sealants, fabrications

Performance

U-value	Quattro bracket	0.040W/mK insulation
0.26W/m ² K Limiting U-Value for new or replacement walls ADL 2021:Volume 2 incorporating 2023 amendments	180mm	180mm
0.20W/m ² K	220mm	220mm

Other U-values are available. Please refer to our Technical Data Sheets.
Fire resistance of both FR15 and FR30 available. Please contact our [Technical Department](#) for further information.

Elite 60 Range

Euroclad Elite 60 Range is an attractive horizontal cladding solution. The Half Round profile (EC 50-200-1000 Wall) offers something different and this exciting profile helps deliver buildings with walls that are particularly noteworthy. Its attractive half round contour makes it popular with signature designs for leading UK and international brands.

The profile is fixed directly to the Quattro spacer system and compressed quilt insulation is housed between the outer sheet and the EC 19-167-1000 Liner 2 liner sheet. This is a guaranteed system which also meets project specific thermal and acoustic performance requirements.



Specifications

External profile	EC 50-200-1000 Wall Profile 0.7mm steel Colorcoat Prisma®
Spacer system	Quattro Bracket and Quattro Bar
Insulation	0.040W/mK Lambda insulation as standard
Internal profile	Euroclad EC 19-167-1000 Liner 2 0.4mm steel
System components	Fasteners, flashings, membranes, tapes, mastic and sealants, fabrications

Performance

U-value	Quattro bracket	0.040W/mK insulation
0.26W/m ² K Limiting U-Value for new or replacement walls ADL 2021:Volume 2 incorporating 2023 amendments	180mm	180mm
0.20W/m ² K	220mm	220mm

Other U-values are available. Please refer to our Technical Data Sheets.
Fire resistance of both FR15 and FR30 available. Please contact our [Technical Department](#) for further information.

Case Study

Project

Silverstone Park

Products

Euroclad Elite Systems

Walls: Elite Plus 57

Roof: Elite Plus 2

Location

Towcester



The Project

Silverstone Park in Northamptonshire is a global engineering and technology park offering a unique industrial space for innovative and high-tech businesses and it aspires to become the biggest tech hub in the UK and it is already attracting businesses from around the world with its first-class facilities.

The park is currently in phase 3 of development which saw work start on the park's biggest buildings to date, with the largest of the four new buildings measuring 97,956 sq ft.

The Challenge

Euroclad worked with MEPC to deliver roof and wall systems for phase 3 which needed good acoustic and thermal performances to manage the greater sound and environmental management challenges they faced.

Sustainability lies at the heart of Silverstone Park, so it was vital to ensure the buildings were as efficient as possible.

Action

The lightweight 'Elite Plus 2' roof system was chosen in 'Anthracite Grey' to cover 22,000m² of roof space, creating a sleek, modern look in keeping with the park's innovative ethos.

For the walls, 7,377m² of the Elite Plus 57 wall system was used in both 'Anthracite Grey' and 'Metallic Silver' to striking effect. This horizontal, sinusoidal system is an economical cladding solution that can be guaranteed for up to 30 years.

Results

Working with installer ABS Elbow, Euroclad's products were delivered and installed on time and within budget. The systems delivered an attractive and modern appearance that instantly drew tenants to the park. Client MEPC was so pleased with the products' performances and finish that they have already specified the same Euroclad products for the next two exciting new phases of Silverstone Park.

Colorcoat Prisma® by Tata Steel

The latest generation pre-finished steel product, three layer Colorcoat Prisma® utilises cutting edge clear coat technology. This technology provides an optimised pre-finished steel product that pushes the boundaries of UV and corrosion performance. This enables a wide range of contemporary aesthetic colours that are truly built to last.

Key Features and Benefits

- Revolutionary 3-layer technology, providing enhanced aesthetics and long term performance and durability.
- Meets the highest European standards for corrosion and UV resistance (Ruv5 and RC5+ as per EN 10169:2022).
- Optimised Galvalloy® metallic coating for ultimate corrosion resistance and cut edge protection.
- Independently tested for liberation of volatile organic compounds (VOC) against EN ISO 16000-9 and achieved an A+ rating.
- Fully REACH compliant & free of chromates including hexavalent chrome.
- Confidex® Guarantee for up to 40 years when registered for [online](#).

Colorcoat HPS200 Ultra® by Tata Steel

Designed to withstand even the most demanding and aggressive environments, Colorcoat HPS200 Ultra® pre-finished steel provides super durability and corrosion resistance with proven performance. Guaranteed for up to 40 years it is backed up with even more extreme testing and real world global data. This offers a sustainable solution for the building envelope where longevity and durability are imperative over the life of the building.

Key Features and Benefits

- Meets RUV4 and surpasses RC5+ as per EN 10169:2022 proving excellent colour and gloss retention and corrosion resistance.
- Optimised Galvalloy® metallic coating for exceptional corrosion resistance and cut edge protection.
- Scintilla® embossed as a mark of authenticity from Tata Steel.
- Exceeds requirements of CPI5 as per EN 10169 demonstrating excellent barrier properties when used internally.
- Independently tested for liberation of volatile organic compounds (VOC) against EN ISO 16000-9 and achieved an A+ rating.
- Fully REACH compliant & free of chromates including hexavalent chrome.
- Confidex® Guarantee for up to 40 years when registered for [online](#).

Confidex® Guarantee

Upon online registration, the Confidex® Guarantee is offered directly to the building owner with no inspection or maintenance to maintain its validity except when used on a roof or wall that has a Photovoltaic (PV installation).

The Confidex® Guarantee is clear and simple and, unlike many other guarantees, offers full remedial action in the unlikely event of coating failure.

To demonstrate Tata Steel's commitment to the environment and renewable energy offerings, Colorcoat HPS200 Ultra® and Colorcoat Prisma® provides the comprehensive Confidex® Guarantee for the pre-finished steel that is under clip and fix photovoltaic (PV) frame modules on a roof or wall. This provides the building owner with the confidence that installing a PV array will not have a detrimental effect on the performance of the pre-finished steel, and that all parts of the roof and wall are covered for the same duration of the Confidex® Guarantee for up to 40 years.

Contact Us

We recognize the need for first class technical support to ensure optimised design both functionally and aesthetically.

Euroclad Group provides a comprehensive technical service which can assist in correct specification, detailing and installation of Elite Roof and Wall systems.

For support contact:

T: +44 (0) 2922 010101

E: rcs.technical@eurocladgroup.com



Building a Better Future Together

Euroclad Group Limited

Wentloog Corporate Park
Wentloog Road, Cardiff CF3 2ER
United Kingdom

Phone: +44 (0) 2922 010101

Email: enquiries@eurocladgroup.com

www.eurocladgroup.com



Please scan the QR code or [click here](#) for the most up to date version of this document.



Care has been taken to ensure that the contents of this publication are accurate, but Euroclad Group Ltd and its subsidiary companies do not accept responsibility for errors or for information that is found to be misleading. Suggestions for, or description of, the end use or application of products or methods of working are for information only and Euroclad Group Ltd and its subsidiaries accept no liability in respect thereof.

Colorcoat®, Colorcoat HPS200 Ultra®, Colorcoat Prisma®, Confidex® and Galvalloy® are registered trademarks of Tata Steel UK Limited.

07/02/2024: Version 4

